



The Old Granary Loop Farm Road, Lytchett Matravers, Poole, Dorset,  
BH16 6D11

**£350,000**

- Three/Four Bedrooms
- Rural Location
- Courtyard Development
- Rural Views From Balcony
- Ideal Compact Family Home or Investment
- Barn Conversion
- Garage
- En-suite Shower Room
- Modern Throughout
- No Forward Chain

# The Old Granary Loop Farm Road, Poole BH16 6BU

No Forward Chain! We are pleased to offer for sale this beautiful barn conversion situated towards the end of an idyllic rural road In Lytchett Matravers. Fantastic rural views!



Council Tax Band: D



### Loop Farm Road

An ideal compact family home or weekend property with good access to rural walks, village amenities, the coast and major roads to town centres. Surrounded by farmland and fields, this property really is situated in a unique and enviable position.

Access via the entrance with a potential bedroom/study and double bedrooms with en-suite shower room on the ground floor. On the first floor is a sitting room with westerly rural views and doors to a spacious balcony. There's also a kitchen/dining room, further double bedroom, small bedroom/study/dressing room and shower room.

There is a garage, parking and small outside area beneath the balcony laid to artificial grass.

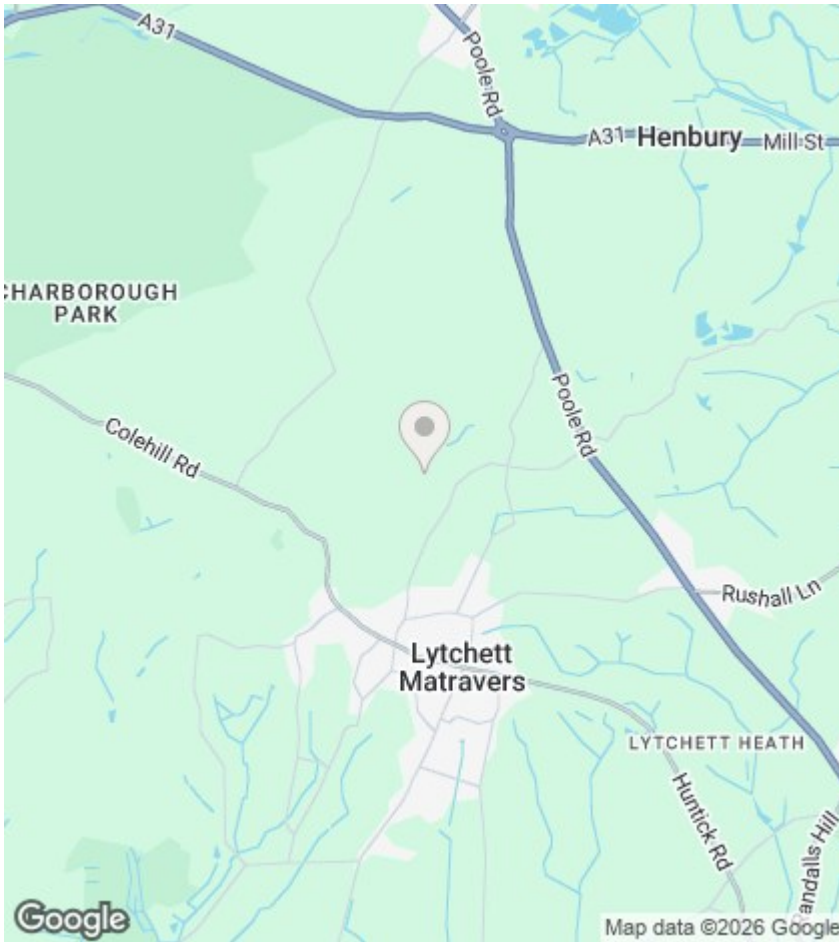

## Agents Note

Whilst every attempt has been made to ensure the accuracy of details and measurements contained in these particulars, they are not to be relied upon especially when potential cost could be incurred. No appliances have been tested so the agent cannot verify that they are in working order. The agent has not seen any legal documentation to verify the legal status of the property. This must be verified by your chosen solicitor.

## Viewings

Viewings by arrangement only. Call 01202 622101 to make an appointment.

## EPC Rating:

D

Energy Efficiency Rating		Current	Potential
Very energy efficient - lower running costs			
(92 plus) <b>A</b>			<b>100</b>
(81-91) <b>B</b>			
(69-80) <b>C</b>			
(55-68) <b>D</b>		<b>68</b>	
(39-54) <b>E</b>			
(21-38) <b>F</b>			
(1-20) <b>G</b>			
Not energy efficient - higher running costs			
<b>England &amp; Wales</b>		EU Directive 2002/91/EC	

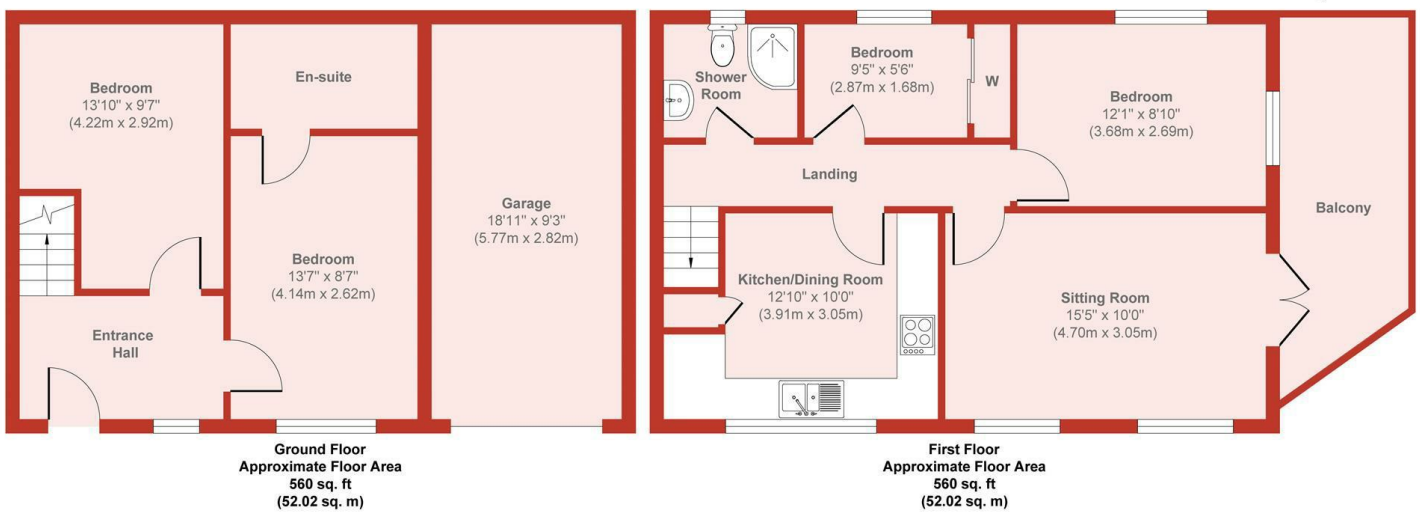

**Approx. Gross Internal Floor Area 1120 sq. ft / 104.04 sq. m**

Produced by Elements Property